

FEATURES

- Forged chambers
- Rigid construction
- Laser welded diaphragm
- Optional exotic materials

APPLICATION

- Separation systems
- Isolation applications
- Viscous & corrosive media
- High-pressure applications
- High vibration application

Direct Coupled



STANDARD SPECIFICATIONS

Range type	: -1...0 bar & 0...70 bar
Top chamber material	: AISI 304 SS
Diaphragm	: AISI 316 SS
Gaskets	: PTFE
Bottom chamber material	: AISI 316L SS
Instrument connection	: 1/2" NPT (F)
Sealing fluid	: Silicon DC 200 (-40...205°C)
Process connection	: 1/2"NPT (M)
Protection on wetted parts	: Optional
Assembly	: Direct
Capillary	: Optional
Armour	: Optional
Remote mounting length	: Optional

DIMENSIONAL DRAWING

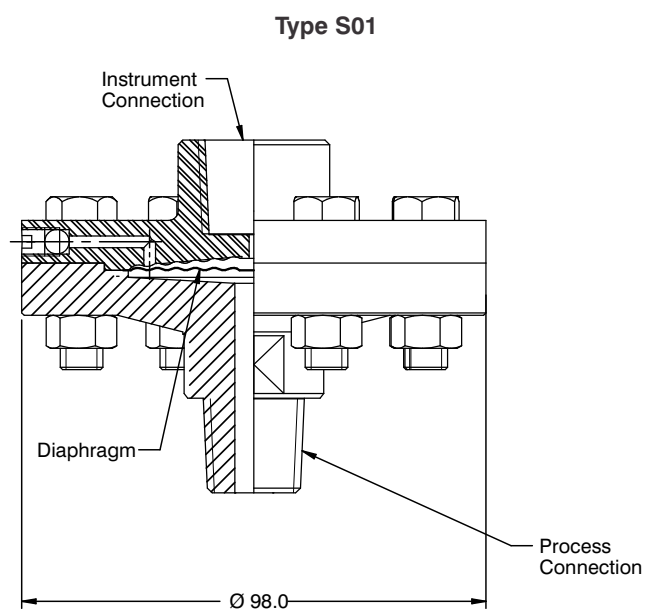

All dimensions are in mm.

DIMENSIONAL DRAWING

Type S02

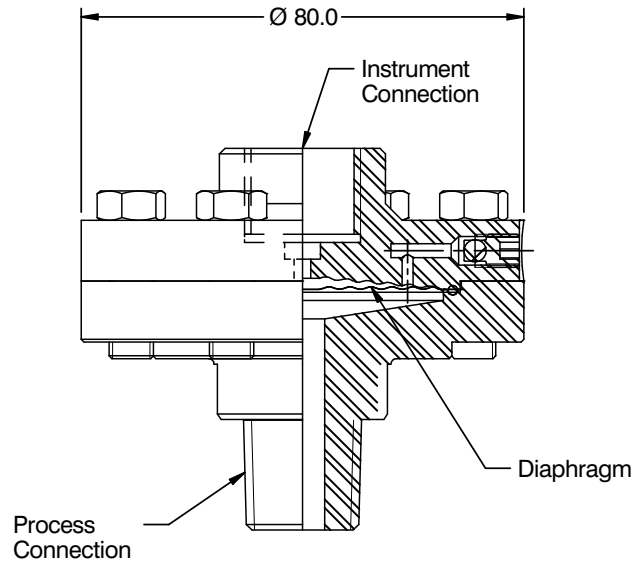

Type S03

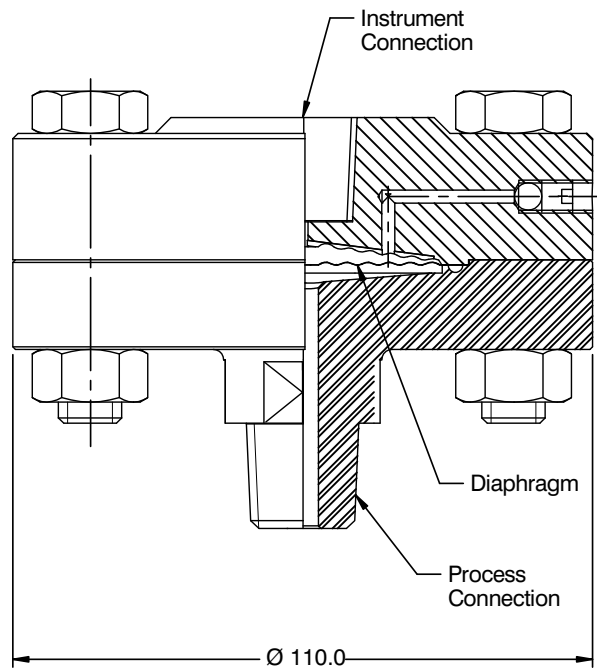

ORDERING CODES

1. RANGE TYPE

S01/S09 -1...0 bar & 0...70 bar
S02/S10 100...160 bar
S03 210...400 bar

S01

2. TOP CHAMBER MATERIAL

LC AISI 304 SS **LF** AISI 316 SS
LG AISI 316L SS

LC

3. DIAPHRAGM MATERIAL

DG AISI 316L SS **DM** Monel 400
DO Hastelloy C-276 **DQ** Inconel 600
DV Titanium **DW** Tantalum
D8 Silver coated

DG

4. GASKETS

RP PTFE **RM** Metal

RP

5. BOTTOM CHAMBER MATERIAL

NC AISI 304 SS **NF** AISI 316 SS
NG AISI 316L SS **NM** Monel 400
NO Hastelloy C-276 **NV** Titanium
NW Tantalum **N1** PVC¹
N2 PTFE¹ **N3** PVDF¹
N4 Polypropylene¹

NF

6. INSTRUMENT CONNECTION

03B 3/8" BSP (F) **04N** 1/2" NPT (F)
02B 1/4" BSP (F) **04B** 1/2" BSP (F)
02N 1/4" NPT (F)

04N

7. SEALING FLUID

OA Silicon DC 200 [-40°C to 205°C]
OF Food grade oil [-20°C to 140°C]
OG Glycerine [10°C to 150°C]
OI Syltherm 800 [-40°C to 315°C]
OL Silicon DC 710 [7°C to 371°C]

OA

8. PROCESS CONNECTION

12B 1/4" BSP (M) **13B** 3/8" BSP (M)
14B 1/2" BSP (M) **15B** 3/4" BSP (M)
12N 1/4" NPT (M) **14N** 1/2" NPT (M)
15N 3/4" NPT (M) **14M** M20 x 1.5 (M)
17M M33 x 2.0 (M) **02N** 1/4" NPT (F)
04N 1/2" NPT (F) **05N** 3/4" NPT (F)
02B 1/4" BSP (F) **04B** 1/2" BSP (F)
05B 3/4" BSP (F)

14N

9. PROTECTION ON WETTED PARTS

PA PTFE lining on bottom chamber ⁴
PB PTFE protection for diaphragm
PC PTFE coating on diaphragm or wetted parts

XX

10. ASSEMBLY

B8 Direct
B9 Remote (capillary)

B8

11. CAPILLARY

OU AISI 304 SS **OV** AISI 316 SS

XX

12. ARMOUR

OX AISI 304 SS **OY** AISI 316 SS
OZ PVC (Ambient max. 60°C)

XX

13. REMOTE MOUNTING LENGTH

XXXX 1000 mm up to 6000 mm

XXXX

14. OTHER OPTIONS

XZ Dry seal
HL Helium leak test
TM Material test certificate 2.2
TC Material test certificate 3.1
E8 Weld constructed bottom chamber (Eco version)

XX

Ordering Example : D101-S01-LC-DG-RP-NF-04N-OA-14N-XX-B8

NOTES:

1. Pressure rating up to 10 bar. Consult factory for details.
2. Other sealing liquids are available, contact factory for further details.
3. All metal diaphragms are laser welded to the top chamber.
4. While choosing option PA for diaphragm DG, option PB has to be selected mandatory.