

FEATURES

- Inert gas filled expansion
- Filled versions
- Bi-metal compensation

APPLICATION

- Liquid & gaseous mediums
- Corrosive environments
- Oil & Gas applications
- Chemical & Petrochemical

Electric Contact, Dome Version



STANDARD PARAMETERS

Accuracy	: CL 1.0 (Class 1)
Ambient temperature	: 0...40°C max at case
Storage & Transport temperature	: -50...+70°C without liquid dampening
	: -20...+60°C with liquid dampening
Over range limits	: 110% full scale
Stem pressure rating	: 25 bar (Without thermowell)
Weld joints	: TIG argon arc welding

MATERIAL OF CONSTRUCTION

Sensing element	: Inert Gas Filled sensor bulb
Case & Ring material	: AISI 304 SS
Stem & Process connection material	: AISI 316 SS
Dial	: Aluminum, black graduation on white background
Pointer	: Micrometer zero adjustable, aluminum, black powder coated
Gaskets	: Neoprene
Window	: Polycarbonate dome

STANDARD SPECIFICATIONS

Dial size	: DN100
Range	: 0...100°C
Mounting pattern	: Direct, Bottom connection
Stem size	: 6.0 mm
Ingress protection	: IP 65
Stem length	: 150 mm
Assembly	: Direct
Process connection type	: Adjustable connection
Process connection	: 1/2" NPT (M)
Electric contact	: Double; Break contact + Make contact
Electrical termination	: 4 pin PG 13.5 connector

STANDARD SPECIFICATIONS : DAMPENING LIQUID FILLED, DIELECTRIC OIL

Gaskets & Filling plugs	: NBR
Dampening liquids	: Dielectric Oil

REFERENCE

EN 13190

DIMENSIONAL DRAWING

Mounting Pattern: B0, Dome type

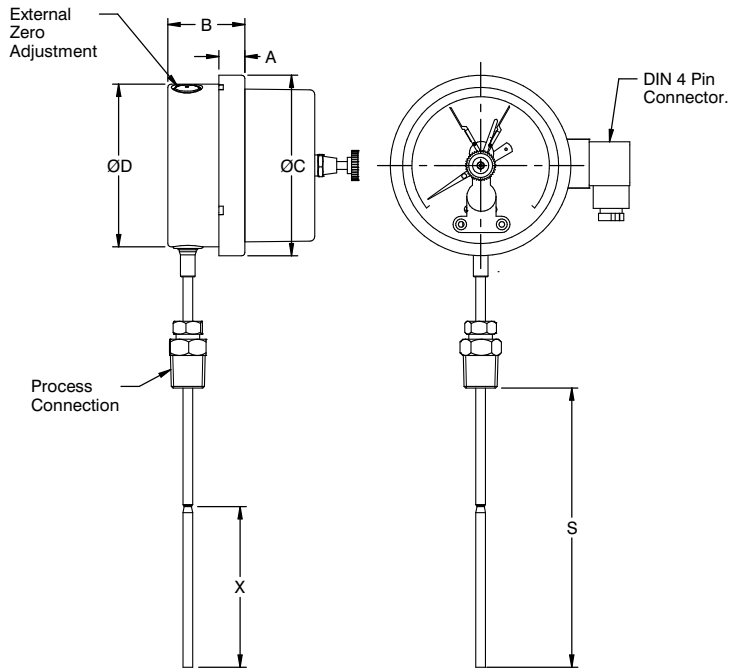

DN	A	B	ØC	ØD	S	X
100	12	48	111	100	*	**
150	15	48	161	149	*	**

* As per customer requirement.
 ** Refer technical sheet - Temperature Gauges.

Mounting Pattern: B1, Dome type

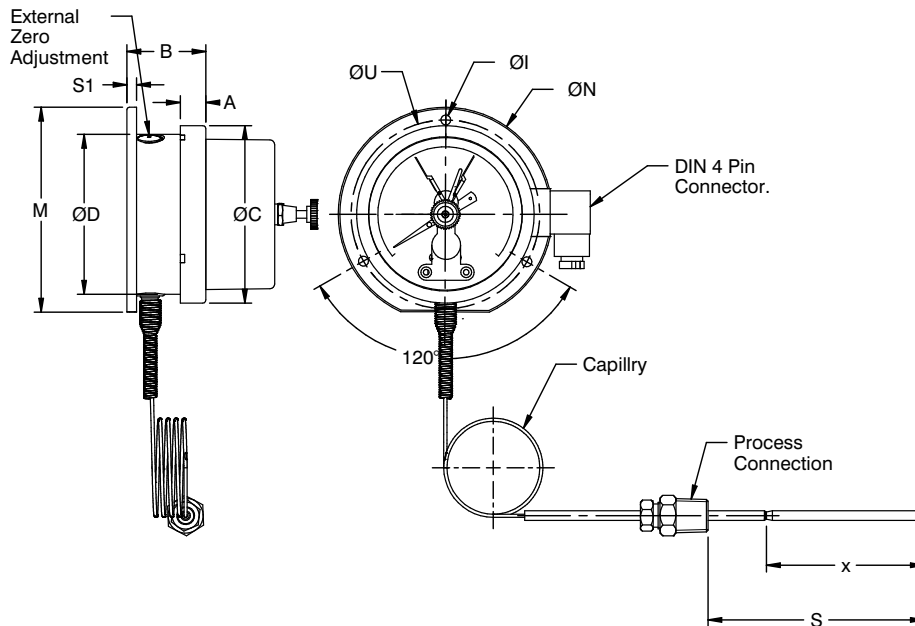

DN	A	B	ØC	ØD	ØI	ØN	M	S1	ØU	S	X
100	12	52	111	100	6	134	128	6	118	*	**
150	15	52	161	149	6	186	172.4	6	168	*	**

* As per customer requirement.
 ** Refer technical sheet - Temperature Gauges.

All dimensions are in mm.

DIMENSIONAL DRAWING

Mounting Pattern: R0, Dome type

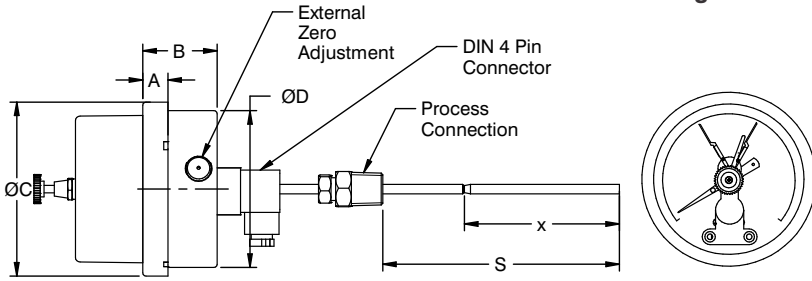

DN	A	B	ØC	ØD	S	X
100	12	48	111	100	*	**
150	15	48	161	149	*	**

* As per customer requirement.
** Refer technical sheet - Temperature Gauges.

Mounting Pattern: R1, Dome type

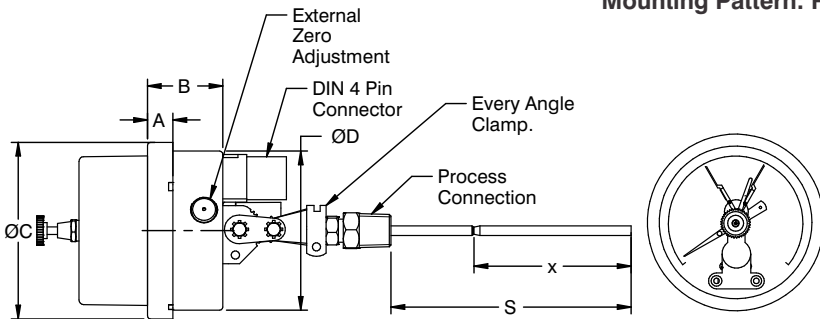

DN	A	B	ØC	ØD	S	X
100	12	48	111	100	*	**
150	15	48	161	149	*	**

* As per customer requirement.
** Refer technical sheet - Temperature Gauges.

Mounting Pattern: L0, Dome type

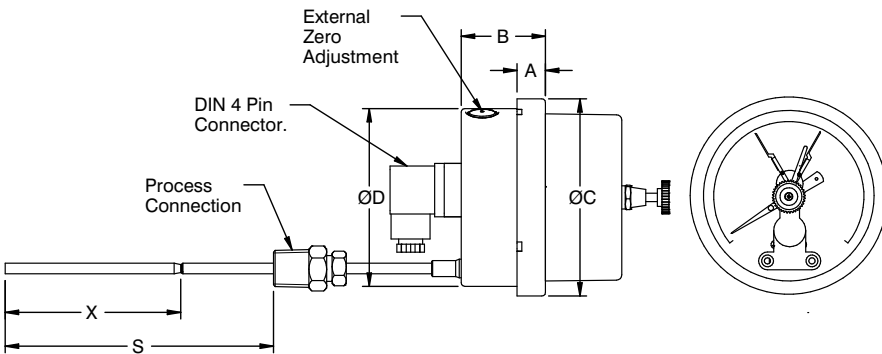

DN	A	B	ØC	ØD	S	X
100	12	48	111	100	*	**
150	15	48	161	149	*	**

* As per customer requirement.
** Refer technical sheet - Temperature Gauges.

Mounting Pattern: L1, Dome type

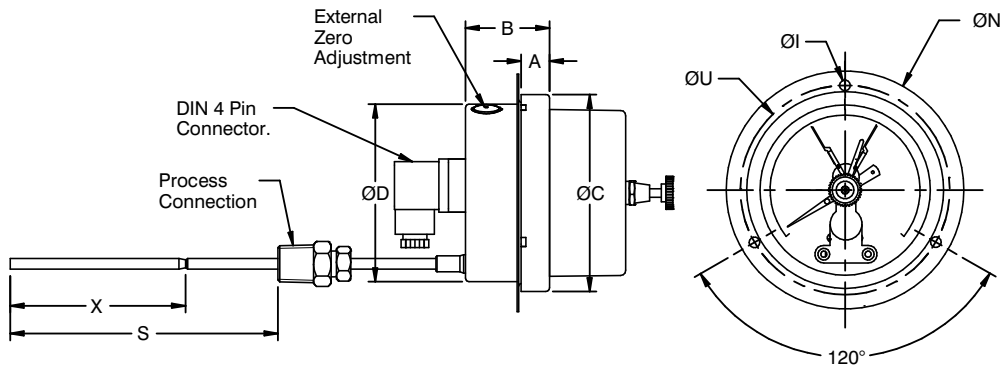

DN	A	B	ØC	ØD	ØI	ØN	ØU	S	X
100	12	48	111	100	6	134	118	*	**
150	15	48	161	149	6	186	168	*	**

* As per customer requirement.
** Refer technical sheet - Temperature Gauges.

DIMENSIONAL DRAWING

Mounting Pattern: L1, Dome type

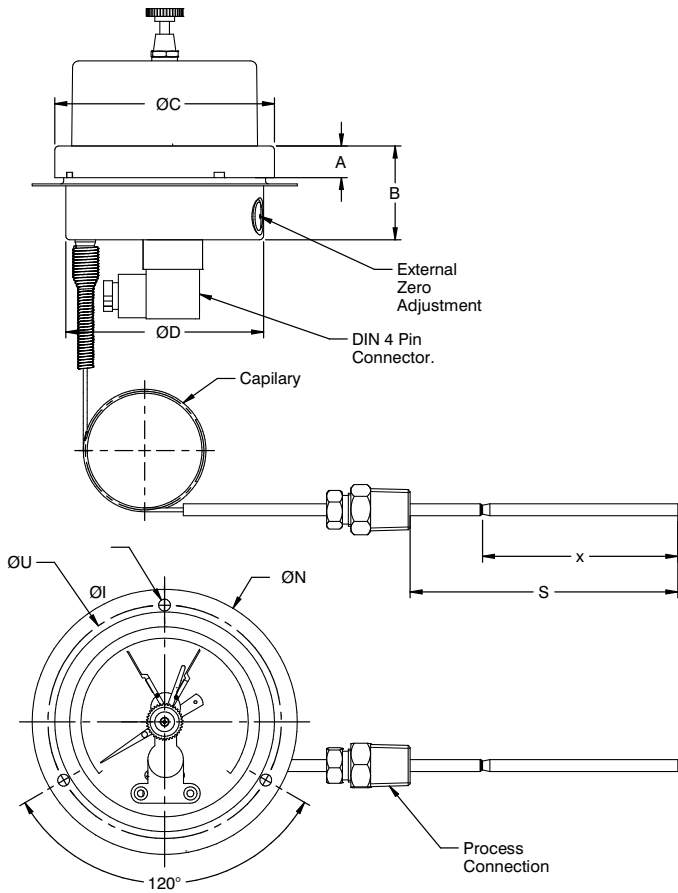

DN	A	B	ØC	ØD	ØI	ØN	ØU	S	X
100	12	48	111	100	6	134	118	*	**
150	15	48	161	149	6	186	168	*	**

* As per customer requirement.
 ** Refer technical sheet - Temperature Gauges.

All dimensions are in mm.

Mounting Pattern: L2, Dome type

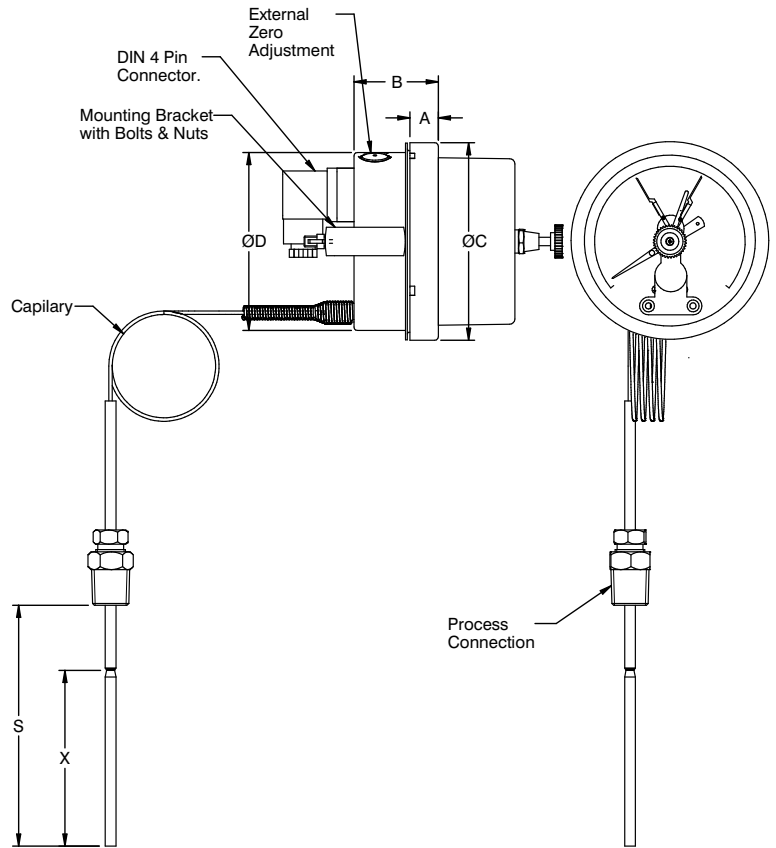

DN	A	B	ØC	ØD	J	K	V	S	X
100	12	48	111	100	72	16	108	*	**
150	15	48	161	149	106.5	16	158.5	*	**

* As per customer requirement.
 ** Refer technical sheet - Temperature Gauges.

RANGE TABLE

RANGE	" °C "	RANGE	" °C "	RANGE	" °C "
-20...+40	C01	-50...+100	C11	0...250	C21
-20...+60	C02	-100...+60	C12	0...300	C22
-20...+80	C03	0...50	C13	0...400	C23
-20...+100	C04	0...60	C14	0...500	C24
-20...+120	C05	0...80	C15	0...600	C25
-20...+180	C06	0...100	C16	0...650	C26
-30...+50	C07	0...120	C17	50...650	C27
-30...+70	C08	0...150	C18	100...600	C28
-40...+40	C09	0...160	C19	100...700	C29
-40...+60	C10	0...200	C20		

NOTES

- For other ranges, please contact factory.
- Equivalent scales available in °F, °C/°F, °F/°C.

ORDERING CODES

1. DIAL SIZE		04	12. REMOTE MOUNTING LENGTH		XXXXX	
04	100 mm / 4"		06	150 mm / 6"		XXXXX
2. RANGE		C16			XX	
XXX	Refer "Range Table"					
3. MOUNTING PATTERN		B0	13. SWITCH CATEGORY		XX	
B0	Direct, Bottom connection					
B1	Wall/Surface/Projection mounting, Bottom connection	M60	14. ELECTRIC CONTACT		Cs1	
B2	2" Pipe/Yoke mounting, Bottom connection					
R0	Centre Back connection	ER			XX	
R1	Every Angle mounting, Centre Back connection					
L0	Lower, Back connection	300			XX	
L1	Panel/Front flange mounting, Lower Back connection					
L2	Panel/bracket mounting, Lower Back connection	KW			XX	
4. STEM DIAMETER						
M60	6.0 mm	I14	1/4" (6.35 mm)			
M80	8.0 mm	M95	9.5 mm			
M10	10 mm	M12	12 mm			
5. INGRESS PROTECTION		14N	15. OTHER OPTIONS		XX	
ER	IP 65		ES	IP 66		
ET	IP 67					
6. STEM LENGTH		B8			XX	
XXXX	Up to 2000 mm (Confirm factory before ordering)					
7. PROCESS CONNECTION TYPE		XX			XX	
KX	Fixed connection					
KW	Adjustable connection	XX			XX	
BW	Swivel / Revolving connection					
8. PROCESS CONNECTION		XX			XX	
14N	1/2" NPT (M)		14B	1/2" BSP (M)		
12N	1/4" NPT (M) ⁴	12B	1/4" BSP (M) ⁴			
14M	M20 X 1.5 mm (M)	13B	3/8" BSP (M) ⁵			
9. ASSEMBLY		XX			XX	
B8	Direct (Stem type)					
B9	Remote (Capillary type)					
10. CAPILLARY		XX			XX	
OU	AISI 304SS		OV	AISI 316 SS		
11. ARMOUR		XX			XX	
OX	AISI 304SS		OY	AISI 316 SS		
OZ	PVC (Ambient max. 60°C)					

Ordering Example : T708-04-C16-B0-M60-ER-300-KW-14N-B8-XX-XX-XXXXX-XX-CS1

NOTES

- For other ranges, connections, please contact factory.
- Equivalent scales available in °F, °C/°F, °F/°C.
- Option "Case & Ring in AISI 316 SS" is applicable for DN100 & DN150 only.
- 1/4" connections are available up to 1/4" (6.35 mm) stem diameter only.
- 3/8" connections are available up to 10 mm stem diameter only.