

## FEATURES

- Back seating to prevent stem blow-out

## APPLICATION

- Isolation & Venting of gauges, switches & other instruments
- Liquid & gas services

### Miniature



### STANDARD SPECIFICATIONS

Stem type	: Miniature tip stem
Wetted parts	: AISI 316 SS
Instrument connection	: 1/2" NPT (F)
Stem packing	: PTFE
Process connection	: 1/2" NPT (F)
Stem	: Double bonnet
Max. working pressure	: 206.85 bar (3000 psi)
Max. working temperature	: 240°C
"T" bar handle	: AISI 304 SS

### DIMENSIONAL DRAWING

MALE X FEMALE

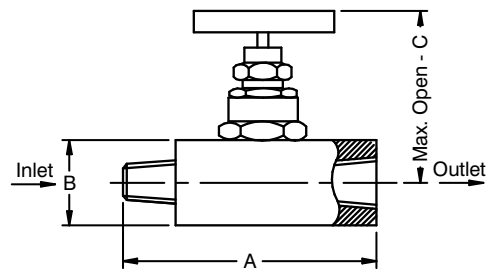

MALE X MALE

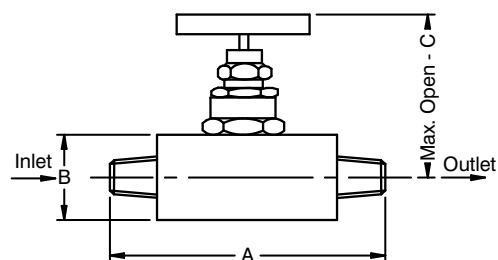

## DIMENSIONAL DRAWING

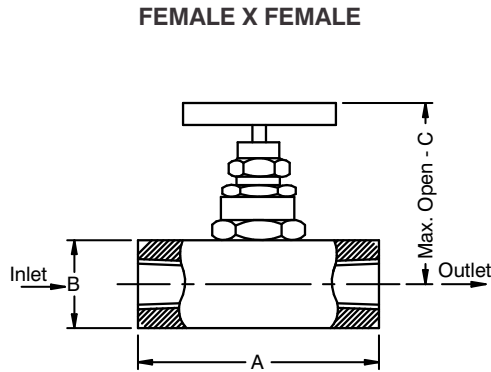

All dimensions are in mm

Size	Type	A	B	Max. open - C
<b>NPT</b> 1/8"	F x F	50	22	56
	M x F	56	22	56
	M x M	60	22	56
<b>NPT</b> 1/4"	F x F	55	22	56
	M x F	50	22	56
	M x M	60	22	56
<b>NPT</b> 3/8"	F x F	55	25	56
	M x F	55	25	56
	M x M	55	25	56
<b>NPT</b> 1/2"	F x F	60	28	50
	M x F	65	28	50
	M x M	50	28	50

## ORDERING CODES

### 1. STEM TYPE

**YS** Miniature tip stem

**YS**

### 2. WETTED PARTS

**MB** Carbon Steel / ASTM A105  
**MC** AISI 304 SS  
**MF** AISI 316 SS  
**MG** AISI 316L SS

**MF**

### 3. INSTRUMENT CONNECTION

<b>11N</b> 1/8" NPT (M)	<b>12N</b> 1/4" NPT (M)
<b>13N</b> 3/8" NPT (M)	<b>14N</b> 1/2" NPT (M)
<b>11B</b> 1/8" BSP (M)	<b>12B</b> 1/4" BSP (M)
<b>13B</b> 3/8" BSP (M)	<b>14B</b> 1/2" BSP (M)
<b>01N</b> 1/8" NPT (F)	<b>02N</b> 1/4" NPT (F)
<b>03N</b> 3/8" NPT (F)	<b>04N</b> 1/2" NPT (F)
<b>01B</b> 1/8" BSP (F)	<b>02B</b> 1/4" BSP (F)
<b>03B</b> 3/8" BSP (F)	<b>04B</b> 1/2" BSP (F)

**04N**

### 4. STEM PACKING

**P** PTFE                      **G** Grafoil

**P**

### 5. PROCESS CONNECTION

<b>11N</b> 1/8" NPT (M)	<b>12N</b> 1/4" NPT (M)
<b>13N</b> 3/8" NPT (M)	<b>14N</b> 1/2" NPT (M)
<b>11B</b> 1/8" BSP (M)	<b>12B</b> 1/4" BSP (M)
<b>13B</b> 3/8" BSP (M)	<b>14B</b> 1/2" BSP (M)
<b>01N</b> 1/8" NPT (F)	<b>02N</b> 1/4" NPT (F)
<b>03N</b> 3/8" NPT (F)	<b>04N</b> 1/2" NPT (F)
<b>01B</b> 1/8" BSP (F)	<b>02B</b> 1/4" BSP (F)
<b>03B</b> 3/8" BSP (F)	<b>04B</b> 1/2" BSP (F)

**04N**

### 6. OTHER OPTIONS

**XY** Circular Handle  
**TN** Tested to NACE standards  
**TO** Certification for Oxygen service  
**TM** Material test certificate 2.2  
**TH** Hydro test certificate  
**TC** Material test certificate 3.1  
**XL** Marking by laser

**XL**

**Ordering Example : V104-YS-MF-04N-P-04N-XL**

#### NOTES:

- Other connections are available, please contact factory for details.
- Valve stem dust covers shall be identified with color codes according to their function as ; Blue = ISOLATE